

**cleanfix**<sup>®</sup>

SWISS MADE QUALITY



**Vacuum Cleaner**

# **S10 models**

Operating instructions for daily use

**Clean. Cleaner. Cleanfix.**

**Cleanfix Reinigungssysteme AG**  
Stettenstrasse 15 | 9247 Henau-Uzwil / SG  
Tel. +41 71 955 47 47 | [info@cleanfix.com](mailto:info@cleanfix.com)  
[www.cleanfix.com](http://www.cleanfix.com)



# S10 Light / S10 plus / S10 plus SL

## User manual



**1 Unwind power cable**  
Check the cable, replace it if damaged



**2 Open vacuum cleaner**  
Release the black flap and lift the upper part



**3 Lift out filter basket**  
Replace it if heavily soiled



**4 Check dust bag**  
If it is full, replace it (see "Inserting the dust bag" below)



**5 Insert filter basket**  
Freely applicable, without predetermined position



**6 Optional S10 Plus: HEPA-Filter**  
Replace it if heavily soiled



**7 Check motor filter**  
Replace it if heavily soiled

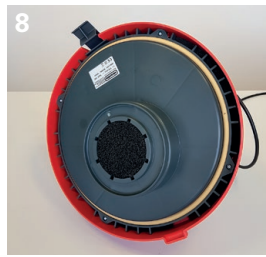

**8 Motor filter**  
Correctly inserted filter



**9.1 Close vacuum cleaner 1**  
Step 1: Guide the upper part at a slight angle into the tab (a)



**9.2 Close vacuum cleaner 2**  
Step 2: Press the flap (b) again



**10 Switch on vacuum cleaner**  
Connect the power cord to power and press the switch

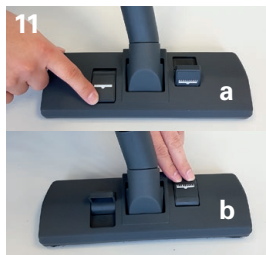

**11 Combi floor nozzle**  
Carpet setting (a)  
Hard floor setting (b)



**12 Missing air supply**  
To clean soft textiles, open the air vent



**13 Clean floor nozzles**  
After use, remove the nozzle and vacuum it



**14 Switch off vacuum cleaner**  
Press the switch and disconnect the power cord



**15 Clean vacuum cleaner**  
Wipe the entire vacuum cleaner with a slightly damp cloth



**16 Winding up the cable**  
Wind the cable tightly under the black ring



**17 Insert suction rod**  
Insert the slide clamp (a) at the handle (b) (model S10 plus)



**18 Suction rod inserted**  
Only possible with the models S10 plus



**19 Storing vacuum cleaner**  
Optionally wrap the hose around the suction tube

### Insert dust bag

We offer dust bags from:

- Textile
- Fleece
- Paper



**1**  
Clean the dust bag connection in the vacuum cleaner if necessary



**2**  
Insert the dust bag  
Observe the "Top Oben" mark on the dust bag



**3**  
Plug in the dust bag tightly



**4**  
Make sure that the dust bag is evenly positioned



**Read the operating instructions before commissioning the machine!**  
Cleanfix Service-Hotline: 079 357 40 33

[www.cleanfix.com](http://www.cleanfix.com)